



MrGreen





Castlemain Avenue

Bournemouth

£150,000

A lovely one-bedroom, ground-floor flat located in Southbourne. This flat is just a short walk from Southbournes buzzing high street and award-winning beaches. It's a great opportunity for first-time buyers, or someone looking for an investment opportunity.

Property Description

Stepping through the front door and heading to your right, you'll find the open-plan kitchen and living area. This room benefits from the morning light flowing through the windows, giving it a bright touch. It's a cosy yet comfortable space, perfect for enjoying a relaxing evening at home. The kitchen is fitted with an electric hob and oven, and space for a washing machine, and large fridge freezer. Going into the bedroom, it's a great size with some good storage space. Lastly, you'll find the bathroom, which is fitted with a shower.

This flat benefits from its own allocated parking space as well as a shared bicycle shed. Being in such a sought-after location, this flat would be a great home for a first time buyer or a potential landlord.

Agent Notes

Tenure – Leasehold

Lease Length – 108 years

Service Charge - £1100 yearly

Ground rent – £100 yearly

Holiday Lets – Not Permitted. Minimum 6month rental contract

Pets – Allowed with consent of management company

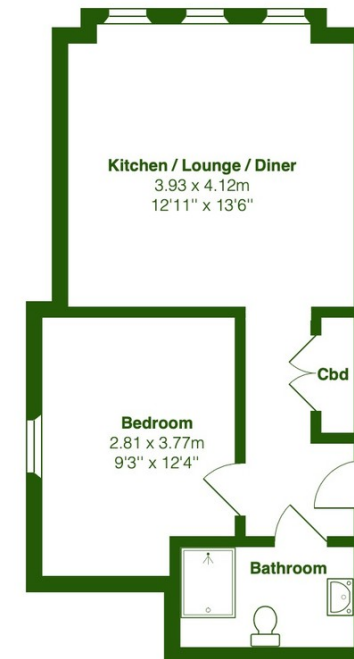

Total Area: 37.4 m² ... 402 ft²

All measurements are approximate and for display purposes only





MrGreen



MrGreen

01202 387718