



For Sale

13 Nursery Close, Plymouth

Offers Over £190,000

 **2**

 **1**

 **1**

 **598 sq ft**

Paul Stone

07798 674649

paul.stone@thepropertyexperts.co.uk

This 2 bedroom property in Tamerton Foliot has been stunningly refurbished by the current owner to a high standard, with a brand new kitchen and bathroom and benefitting from an enclosed rear garden and allocated parking.

Situated in the ever popular hamlet of Tamerton Foliot, this 2 bedroom terraced house is a credit to the owners. The property has been completely refurbished and now beautifully finished throughout, finishing touches such as the living flame effect electric fire, give the property a lovely, homely feel. Both the bathroom and the kitchen have been refitted to a high standard, the windows have been replaced with new UPVC units.

To the rear of the property is an enclosed garden with elevated views over the surrounding woodlands and to the front there is an allocated parking space.

The property is being sold with no onward chain.

Council Tax Band - B

EPC Rating - D

Tenure - Freehold





Ground Floor

Approx. 27.7 sq. metres (298.4 sq. feet)

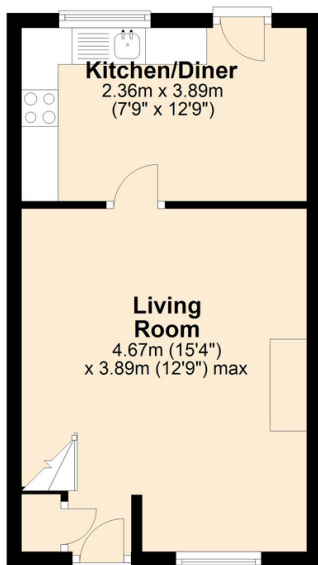

First Floor

Approx. 27.9 sq. metres (300.5 sq. feet)

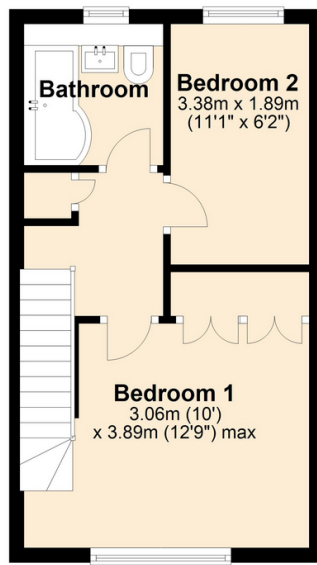

Total area: approx. 55.6 sq. metres (598.9 sq. feet)

- Completely Refurbished 2 Bed House
- New Kitchen and Bathroom
- New PVCu Double Glazing
- Allocated Parking
- Enclosed Rear Garden
- Popular Location
- EPC Rating - D

