



For Sale

4 Victoria Street, Leamington Spa

Offers Over £425,000

***** UNEXPECTEDLY AVAILABLE AGAIN *****

 **2**

 **1**

 **1**

 **84 m2**

Nathaniel Cleaver

07793 363210

nathaniel@thepropertyexperts.co.uk

TRADITIONALLY STYLED BAY FRONTED VICTORIAN END TERRACE PROPERTY THAT HAS BEEN TASTEFULLY RENOVATED THROUGHOUT.

This very well presented Victorian home is situated in a secluded back street next to Victoria Park and close to all local amenities, walking distance to the main shopping Parade and also close to schools and all major transport links and of course the vast array of bars, boutiques, coffee shops and restaurants the town has to offer.

This well-proportioned property has undergone considerable improvements throughout and was stripped back to bare brick.

In brief on the ground floor the property consists of; entrance hallway, living room with large bay window to the front and a working cast iron fire place, separate dining room, and a newly fitted kitchen. There is also access to cellar room which is currently being used as storage.

To the first floor there are two large double bedrooms and brand new four piece family bathroom.

To the rear is a courtyard style garden that is perfect for evening entertaining and a BBQ with



 **The Property Experts**

The Property Experts UK

01926436105

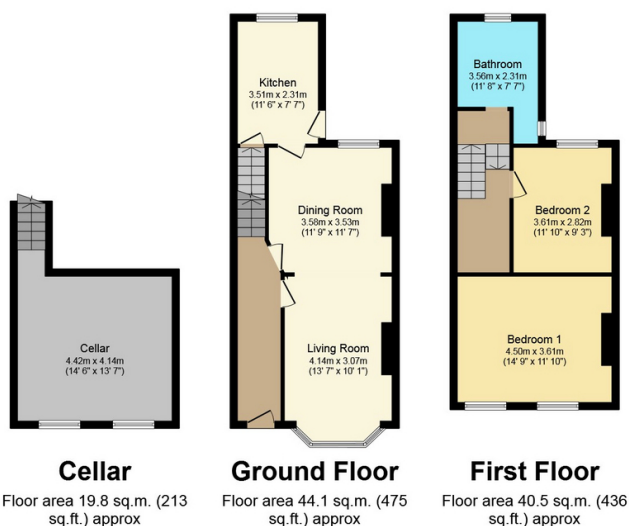

Total floor area 104.4 sq.m. (1,124 sq.ft.) approx

This Floor Plan is for illustration purposes only and may not be representative of the property. The position and size of doors, windows and other features are approximate. Unauthorized reproduction prohibited. © PropertyBOX

- Victorian End Terrace
- Envious Town Centre Location
- Two Double Bedrooms
- Lounge & Separate Dining Room
- Tastefully Renovated From Top To Bottom
- Brand New Kitchen
- Brand New Four Piece Bathroom
- Courtyard Style Rear Garden
- No Onward Chain
- EPC Rating - C

